

EAVES

Northstone Eave Ventilation (with soffit)

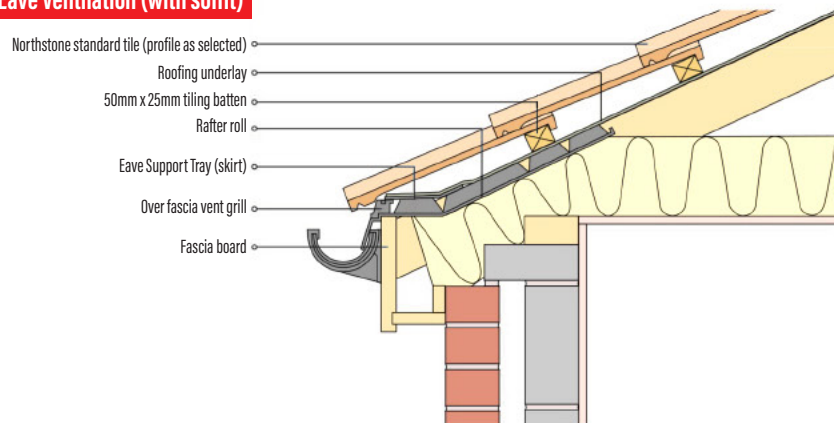

Northstone Eave Ventilation (without soffit)

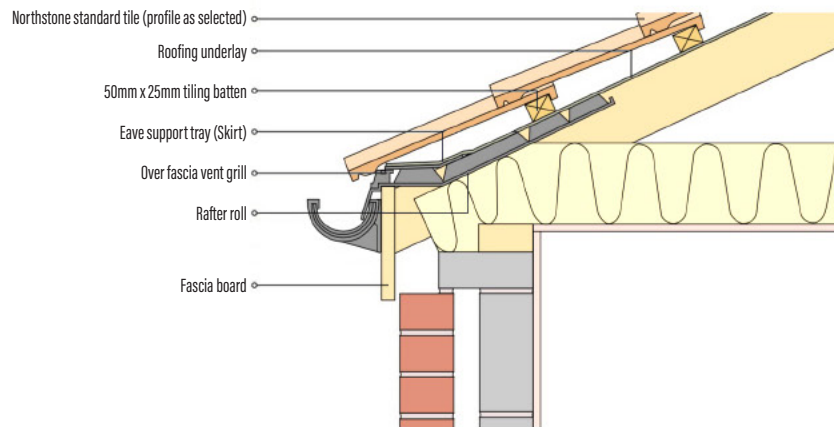

HIPS

Northstone Dry Hip

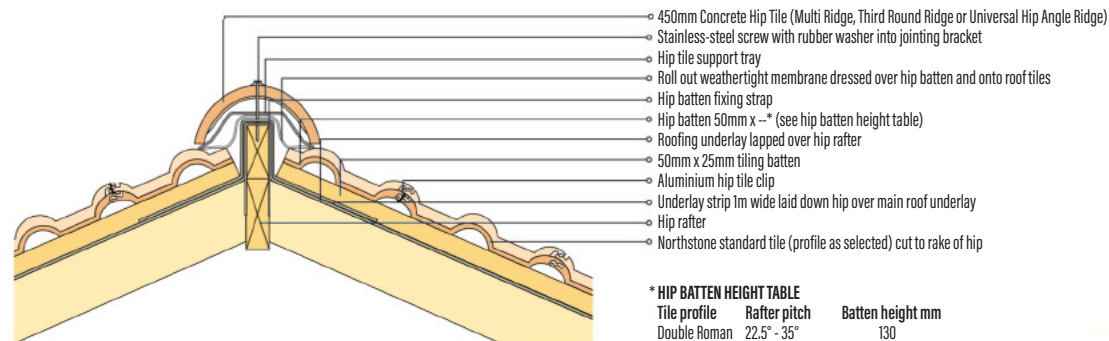

*** HIP BATTEN HEIGHT TABLE**

Tile profile	Rafter pitch	Batten height mm
Double Roman	22.5° - 35°	130
	36.0° - 55°	120
Flat Tiles	22.5° - 30°	115
	31.0° - 55°	105

LEAD VALLEY

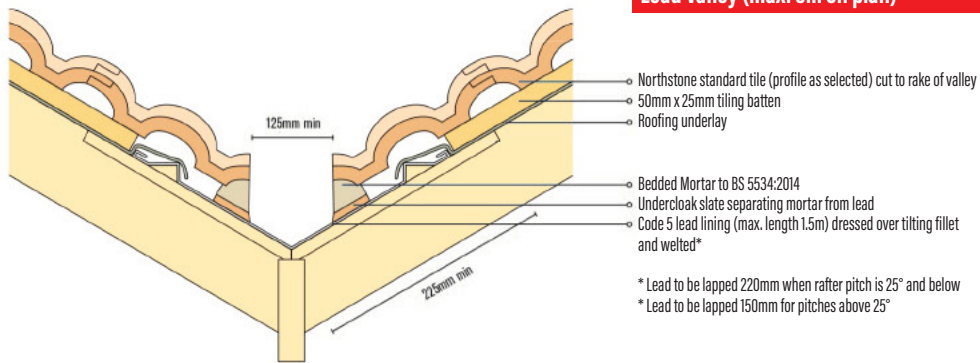

Lead Valley (max. 6m on plan)

* Lead to be lapped 220mm when rafter pitch is 25° and below
* Lead to be lapped 150mm for pitches above 25°

Side Abutment with Profiled Tiles

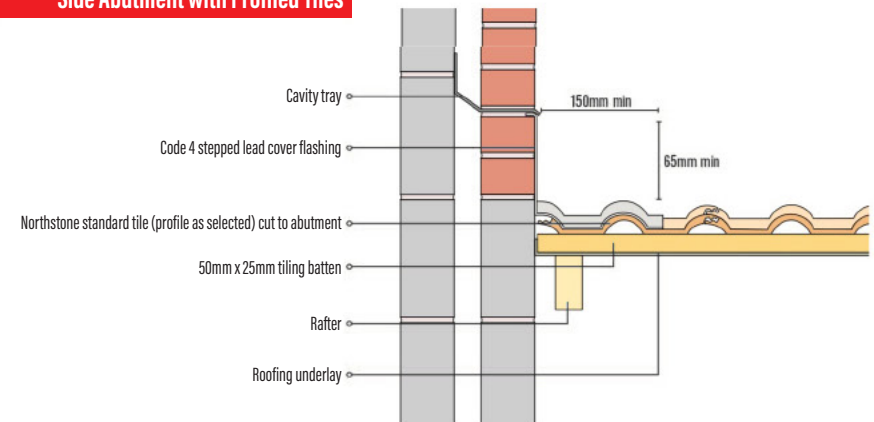

ABUTMENTS

Chimney Abutment

(back gutter)

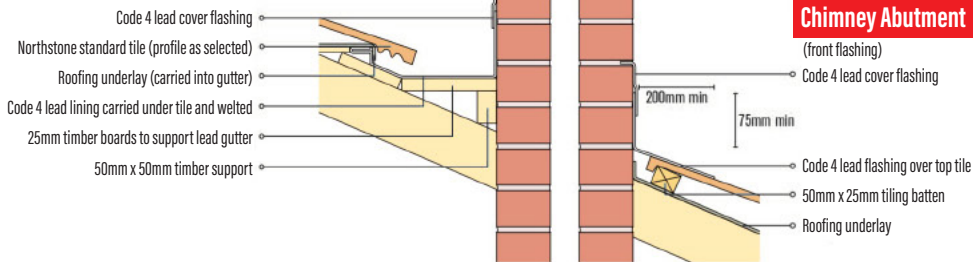

Chimney Abutment

(front flashing)

Side Abutment with Flat Tiles

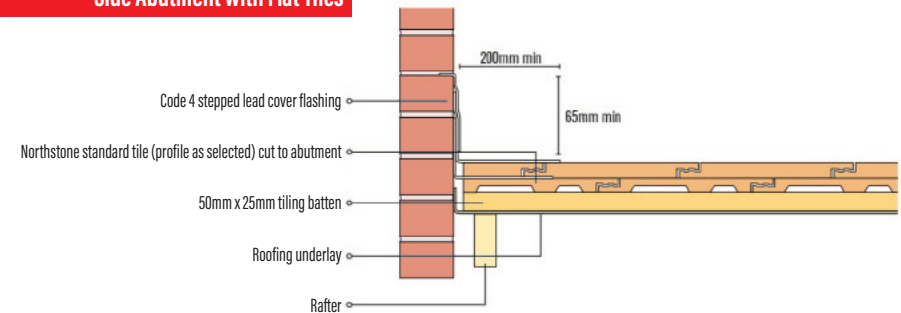

Top Edge Abutment

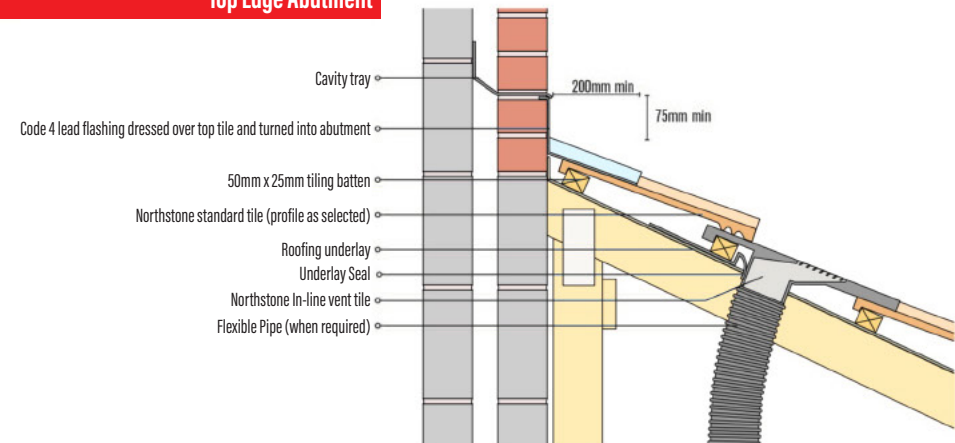

VERGE

Northfast Multi Verge

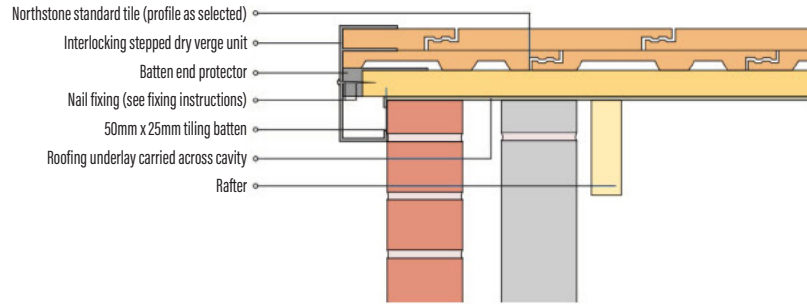

Northstone Continuous Dry Verge

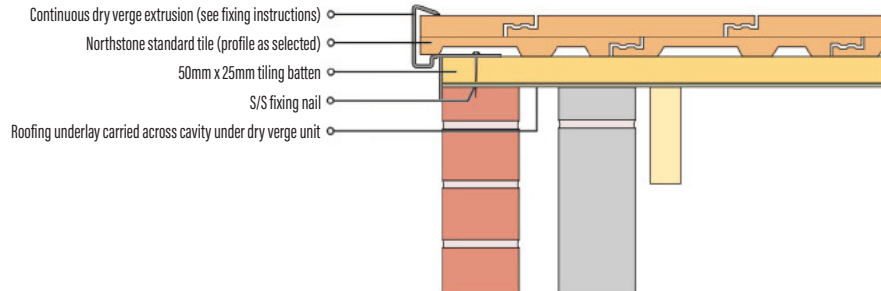

Northstone Bedded Verge

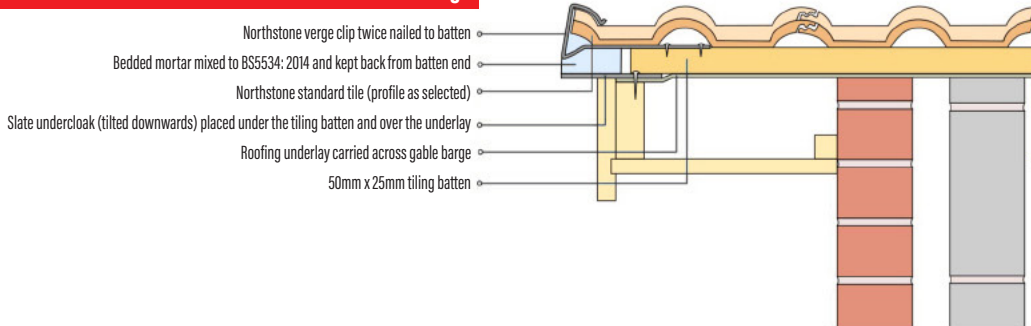

RIDGE

Derrie Dry Vent Ridge Systems, 4.5m

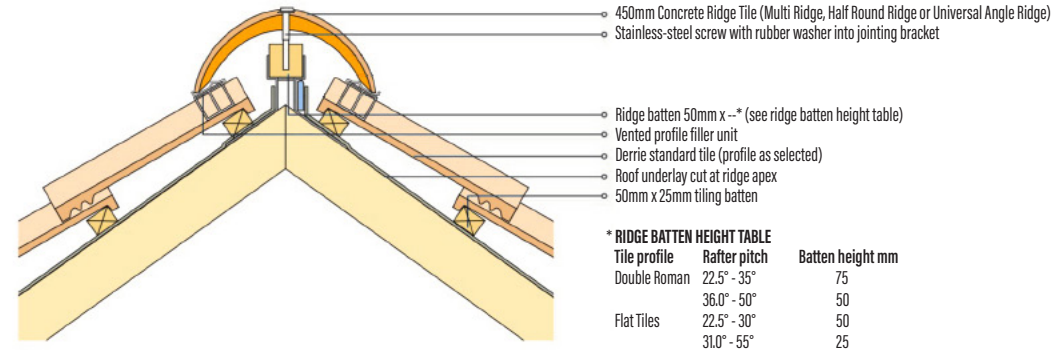

*** RIDGE BATTEN HEIGHT TABLE**

Tile profile	Rafter pitch	Batten height mm
Double Roman	22.5° - 35°	75
	36.0° - 50°	50
Flat Tiles	22.5° - 30°	50
	31.0° - 55°	25

Northfast Universal Dry Ridge System, 6m

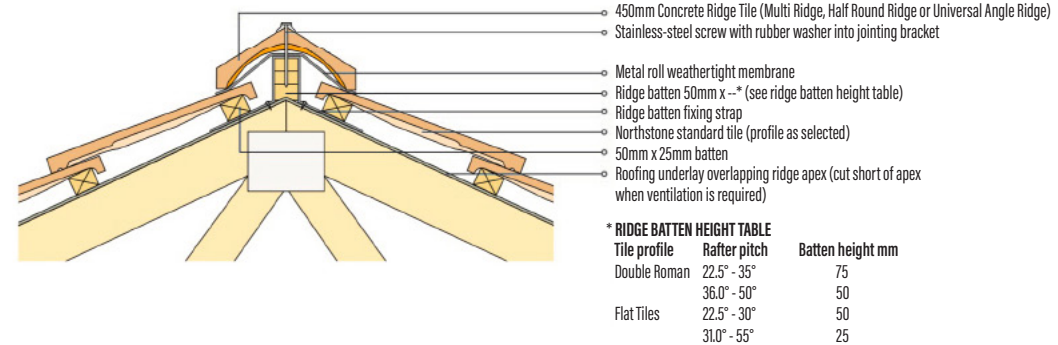

*** RIDGE BATTEN HEIGHT TABLE**

Tile profile	Rafter pitch	Batten height mm
Double Roman	22.5° - 35°	75
	36.0° - 50°	50
Flat Tiles	22.5° - 30°	50
	31.0° - 55°	25

Bedded Ridge

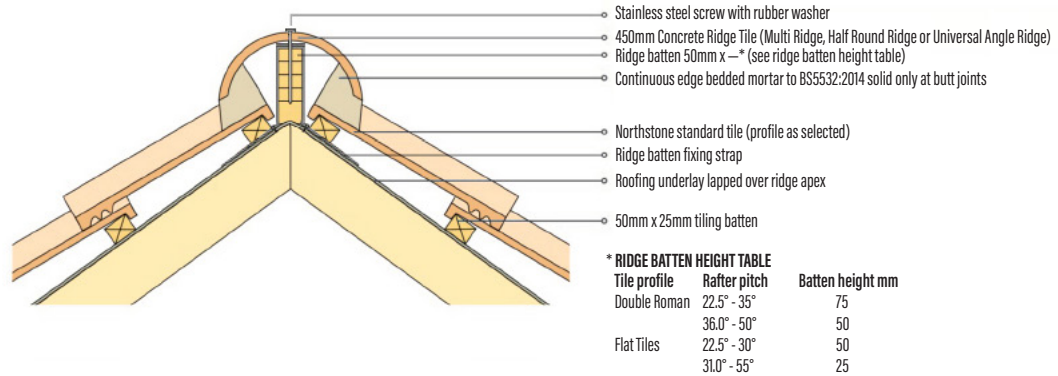

*** RIDGE BATTEN HEIGHT TABLE**

Tile profile	Rafter pitch	Batten height mm
Double Roman	22.5° - 35°	75
	36.0° - 50°	50
Flat Tiles	22.5° - 30°	50
	31.0° - 55°	25

MANSARD

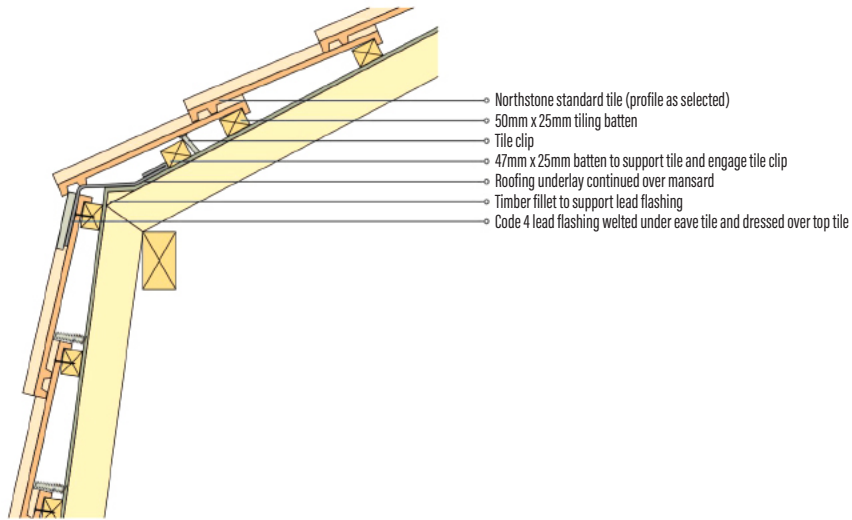

SPROCKET

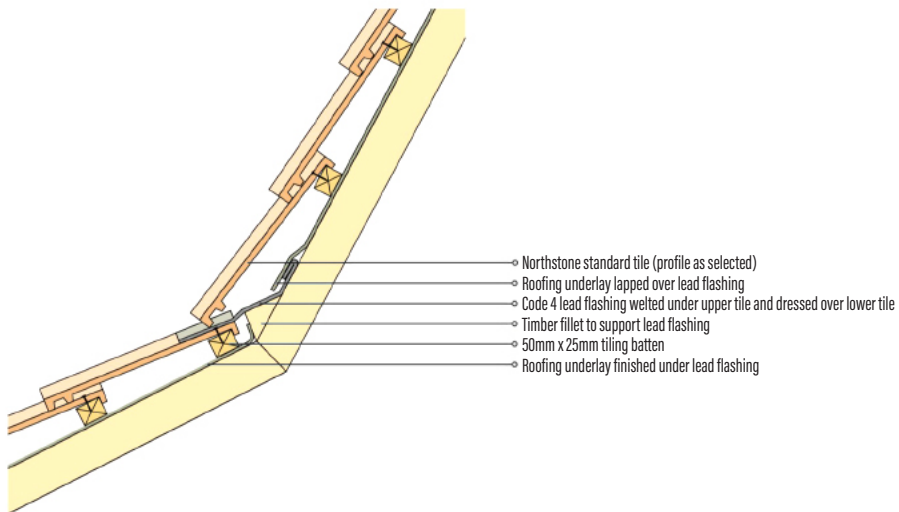

PLAIN / CLADDING TILES

Ventilated Eave (with soffit)

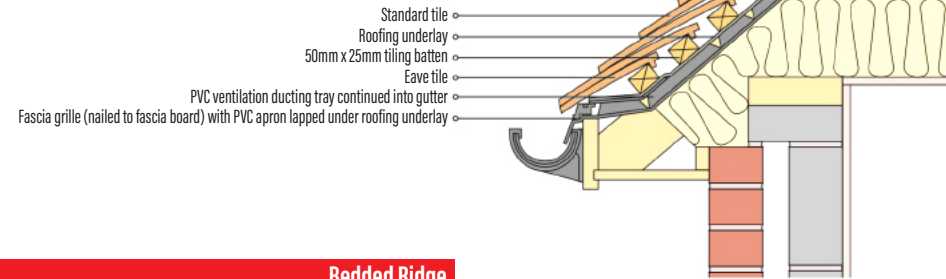

Bedded Ridge

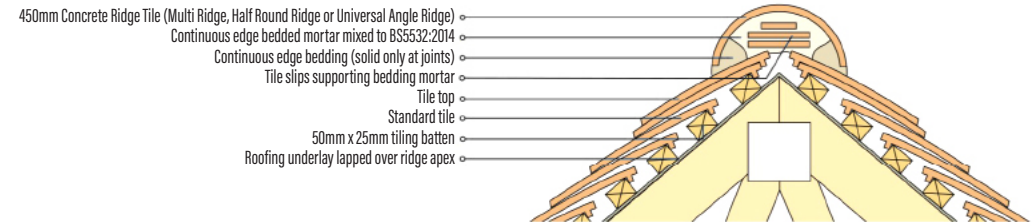

Abutment to Projecting Frame

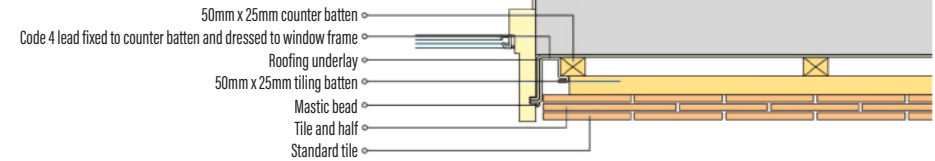

Abutment to Flush Frame

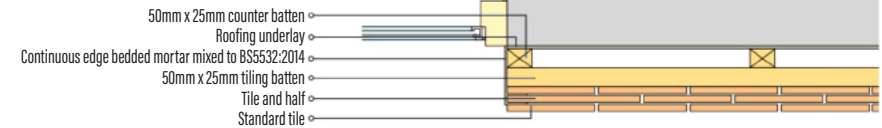

Abutment to Brickwork

